



JAWAKARA
ISLANDS MALDIVES

SEAPLANE TRANSFER POLICY

Jawakara Islands Maldives | Tel +960 662 9999 | reservations@jawakara.com | jawakara.com

Trans Maldivian Airways (TMA) provides seaplane transfers to and from the TMA Terminal located at Velana International Airport (Male' International Airport). The flights are scheduled to coincide with the arrival and departure of international flights. The seaplane transfer time from the TMA Terminal to Jawakara Islands Maldives is a scenic 40-minute flight.

Typically, upon arrival in the Maldives, after clearing immigration and customs, the guest will exit the customs area and enter the Arrivals Hall, proceed to the nearby Crown & Champa Resorts Booth #B9, where a Representative will assist the guest for check-in at TMA Seaplane counter. After seaplane check-in the guest is transferred by bus, from the International Arrival Terminal to the TMA Seaplane Lounge, around 10-minutes away. The guest will wait in the TMA Neeri Lounge area for their scheduled seaplane transfer to Jawakara. The seaplane to Jawakara is normally scheduled to depart within one to two hours of all guests clearing immigration and customs.

In rare instances, such as international flight arrival delays or if a baggage claim form must be completed, the wait would usually be extended.

Guests arriving on an international flight which cannot connect to the last seaplane of the day to Jawakara (usually departs no later than about 16h00) may choose to overnight in nearby Male' at the Champa Central Hotel, or elsewhere. A hotel booking can be arranged by Jawakara team.

- Seaplanes only fly during daylight hours, i.e. between about 06h00 and 18h00.
- International airline policy requires passengers to check-in no later than 2 hours before flight time, therefore a guest can connect to international flights departing Velana International Airport only after 09h00.
- The last flight departure from Jawakara is around 16h00 or earlier subject to seaplane company operation.

The seaplane allowance for checked-in luggage is 20 kg while carry-on luggage is 5 kg per person, above which there will be an excess charge of US\$5.00 per kg, subject to 16% GST. In extraordinary circumstances, luggage may be transported by a later flight (as per safety regulations and TMA policies & procedures).

In rare instances, due to circumstances beyond the control of TMA and/or Jawakara, such as unfavorable weather conditions, the seaplane may depart earlier or later than scheduled to/from Jawakara, in which case, neither TMA nor Jawakara assume liability for any related expenses incurred by guests.

NEERI AIRPORT LOUNGE (TMA SEAPLANE TERMINAL)

Guest can purchase food and beverages and free Wi-Fi while relaxing in air-conditioned comfort or al fresco on the deck until the flight departs.

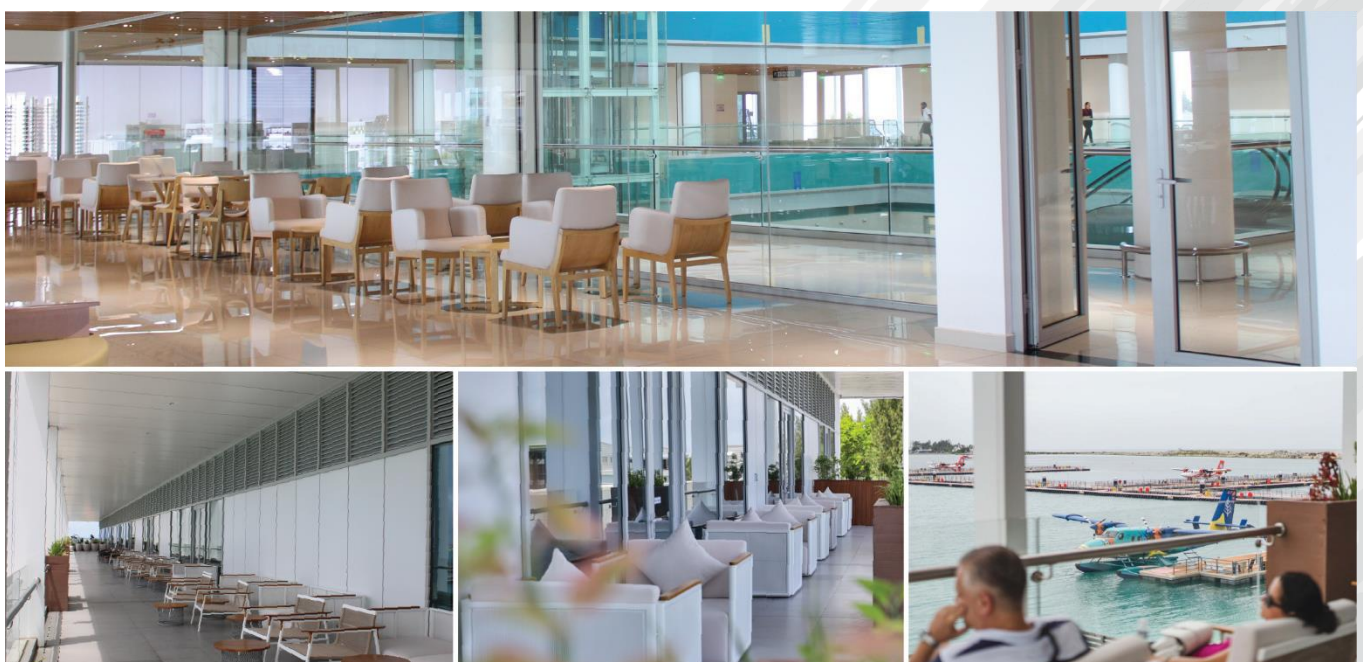

VILU BUSINESS LOUNGE AT SEAPLANE TERMINAL

There is a US\$45 fee, per person, for use of the lounge for maximum 3 hours including the self-service buffet; snacks during normal operational hours and light meals after 18h00. Internet access, newspapers and magazines, international TV channels, flight information, local telephone and wash rooms, family room (comfortable and private area for diaper changing and nursing), kids play areas etc.; are available for all guests. For International departing guests, the lounge is open in the late afternoon so guests can relax in comfort, until we transfer you in the TMA shuttle to the International Departure Terminal to check-in for your flight home. Guests may book the lounge before they arrive in the Maldives or while at Jawakara.



DOMESTIC FLIGHT

Maldivian Airline provides domestic flight transfers to and from the Domestic Terminal located at Velana International Airport (Male' International Airport) to Madivaru Airport and short speedboat from Madivaru Airport to Jawakara Islands Maldives. Flights are scheduled to synchronize with international arrivals/departures, and can be operated on day and night time. Schedule can only be released 3 days in advance and might change due to operational considerations.

Upon arrival in the Maldives, after clearing Immigration and Customs, the guest will exit the Customs area and enter the Arrivals Hall, proceed to counter #B9, our Airport representative will escort to Maldivian counter located in Domestic Terminal nearby Velana International Airport.

Each passenger may carry 20 (twenty) kg of checked luggage and 5 (five) kg of hand luggage free of charge. Any excess luggage is chargeable at the airport during airline check-in and will be an estimated charge of US\$0.65 per kg, excluding taxes.

Domestic transfer should be requested to the resort Reservations with booking request at least 7 days prior to arrival date. International flight details should be provided 7 days prior to arrival date.

Guests arriving on an international flight which cannot connect to the last seaplane of the day to Jawakara (usually departs no later than about 16h00) may choose to book the domestic flight to Madivaru Airport. The flight schedule is planned up until 18h40 from Velana International Airport to Madivaru Airport. Subject to change.

Guests departing on an international flight which is scheduled late in the evening, may choose to book the domestic flight to Velana International Airport. The latest flight from Madivaru Airport is scheduled for 19h30 to Velana International Airport. Subject to change.

In rare instances, due to circumstances beyond the control of the airline and/or Jawakara such as unfavourable weather conditions, or force majeure; the airplane may depart earlier or later than scheduled to/from Madivaru Airport, in which case, neither the airline nor Jawakara assume liability for any related expenses incurred by guests.

MOONIMA AIRPORT LOUNGE (UPON ARRIVAL IN MALDIVES)

Lounge service is available at a charge of US\$ 25 per person (including taxes) for up to 4 hours. Pre-booking is required.

Lounge services includes: snacks, tea, coffee, juice, water, carbonated beverages and Free WIFI.